

JHP FASTENERS, INC

STANDOFFS FOR THIN SHEET MATERIAL

SERIES

Captive - CFT / CFTS / CFTA
 PEM® - TSO / TSOS / TSOA
 JHP Fasteners - TTSO



Manufactured by Captive Fastener Corp

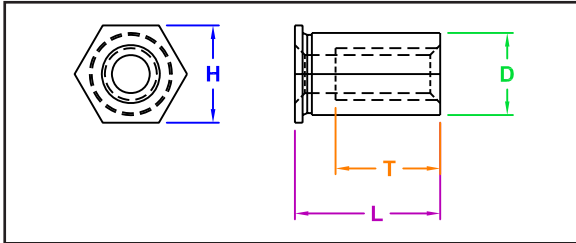

CFT standoffs allow flush-head installation in a material thickness of .025" or more.

INCH

All Dimension are in inches

Thread Size	Part Number	L Length + 0.002 in. - 0.005 in.												Hole Size +0.003 -0.000	D +0.000 -0.005	H Nom	T Min	Min Distance to Edge	Min Matt Thick
		0.90	0.125	0.187	0.250	0.312	0.375	0.437	0.500	0.562	0.625	0.687	0.750						
#2-56	CFT256													0.166	0.165	0.187	0.200	0.23	0.025
	CFTS256	-0.090	-0.125	-0.187	-0.250	-0.312	-0.375	-0.437	-0.500	-0.562	-0.625	-0.687	-0.750						
	CFTA256																		
#2-56	CFT6256													0.213	0.212	0.250	0.27	0.025	
	CFTS6256	-0.090	-0.125	-0.187	-0.250	-0.312	-0.375	-0.437	-0.500	-0.562	-0.625	-0.687	-0.750						
	CFTA6256																		
#4-40	CFT440													0.166	0.165	0.187	0.220	0.23	0.025
	CFTS440	-0.090	-0.125	-0.187	-0.250	-0.312	-0.375	-0.437	-0.500	-0.562	-0.625	-0.687	-0.750						
	CFTA440																		
#4-40	CFT6440													0.213	0.212	0.250	0.27	0.025	
	CFTS6440	-0.125	-0.187	-0.250	-0.312	-0.375	-0.437	-0.500	-0.562	-0.625	-0.687	-0.750							
	CFTA6440																		
#6-32	CFT632													0.213	0.212	0.250	0.270	0.27	0.025
	CFTS632	-0.125	-0.187	-0.250	-0.312	-0.375	-0.437	-0.500	-0.562	-0.625	-0.687	-0.750							
	CFTA632																		
		Full Thread				Partial Thread				Blind Thread									

"PEM" is a registered trademark of Penn Engineering®. Captive Fastener Corporation parts are substitutes for the PEM part numbers in form, fit & function.

JHP Fasteners, Inc.
 610 Maryland NE - Suite B
 Grand Rapids, MI 49505
 Scale NTS

Drawing No
TTSO-I
 Revision

P - 800.783.0910
 P - 616.913.0060
 F - 616.913.0085
 Drawn by:
 M McCormick

JHP FASTENERS, INC

STANDOFFS FOR THIN SHEET MATERIAL

SERIES

Captive - CFT / CFTS / CFTA
 PEM® - TSO / TSOS / TSOA
 JHP Fasteners - TTSO

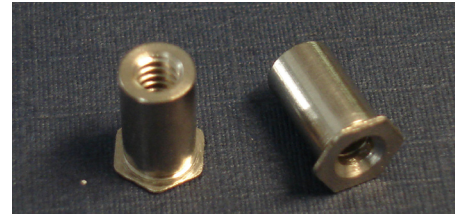

Manufactured by Captive Fastener Corp

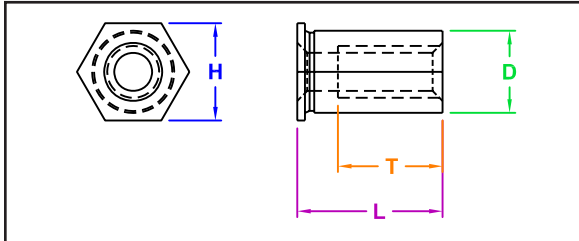

CFT standoffs allow flush-head installation in a material thickness of .63mm or more.

METRIC

All Dimension are in millimeters

Thread Size	Part Number	L Length ±0.08											Hole Size +0.08 -0.00	D +0.000 -0.13	H Nom	T Min	Min	Min Mat'l Thick	
		2.00	3.00	4.00	6.00	8.00	10.00	12.00	14.00	16.00	18.00	19.00							
M2.5	CFTM2.5													4.2	4.19	4.8	5.2	5.8	0.63
	CFTSM2.5	-200	-300	-400	-600	-800	-1000	-1200	-1400	-1600	-1800	-1900							
	CFTAM2.5																		
6M2.5	6M2.5													5.4	5.38	6.4	7.1	0.63	
	CFTS6M2.5	-200	-300	-400	-600	-800	-1000	-1200	-1400	-1600	-1800	-1900							
	CFTA6M2.5																		
M3	CFTM3													4.2	4.19	4.8	6.2	5.8	0.63
	CFTSM3	-200	-300	-400	-600	-800	-1000	-1200	-1400	-1600	-1800	-1900							
	CFTAM3																		
6M3	CFT6M3													5.4	5.38	6.4	7.1	0.63	
	CFTS6M3	-200	-300	-400	-600	-800	-1000	-1200	-1400	-1600	-1800	-1900							
	CFTA6M3																		
M3.5	CFTM3.5													5.4	5.38	6.4	7.0	7.1	0.63
	CFTSM3.5	-200	-300	-400	-600	-800	-1000	-1200	-1400	-1600	-1800	-1900							
	CFTAM3.5																		
Full Thread							Partial Thread		Blind Thread										

"PEM" is a registered trademark of Penn Engineering®. Captive Fastener Corporation parts are substitutes for the PEM part numbers in form, fit & function.

JHP Fasteners, Inc. 610 Maryland NE - Suite B Grand Rapids, MI 49505	Drawing No TTSO-M	P - 800.783.0910 P - 616.913.0060 F - 616.913.0085
Scale NTS	Revision	Drawn by: M McCormick