

## SPRING-TOP STANDOFFS FOR PC BOARDS

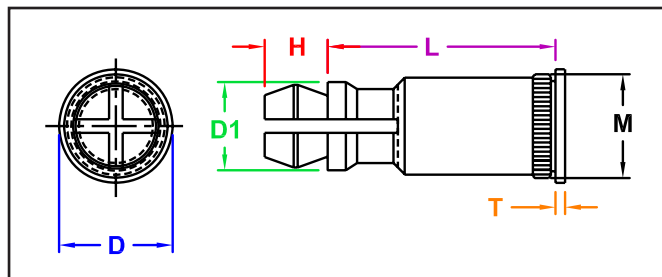

Manufactured by Captive Fastener Corp



CFKSSB spring-top standoffs are designed for permanent installation into PC boards by pressing into a drilled or punched hole. The spring-action post provides quick attachment and removal of PC boards, with a simple snap eliminating the problems associated with loose hardware.

### INCH

All Dimension are in inches									
Part Number	Material	Finish	Hole Dia Top	Hole Dia Bottom	D1 ± 0.005	M Max	D ± 0.005	H ± 0.005	T ± 0.005
CFKSSB156	Brass	Plain	0.156	0.213	0.188	0.228	0.250	0.141	0.020
Mounting Material, Min Thickness - .050									
L Length ± 0.005									
0.250	0.312	0.375	0.437	0.500	0.562	0.625	0.750	0.875	1.000
-8	-10	-12	-14	-16	-18	-20	-24	-28	-32

### METRIC

All Dimension are in millimeters									
Part Number	Material	Finish	Hole Dia Top +.08 -.00	Hole Dia Bottom +.08 -.00	D1 ± 0.13	M Max	D ± 0.13	H ± 0.13	T ± 0.13
CFKSSB4MM	Brass	Plain	4.0	5.4	4.77	5.74	6.35	3.58	0.51
Mounting Material, Min Thickness - 1.25									
L Length ± 0.13									
8	10	12	14	16	18	20	22	25	
-8	-10	-12	-14	-16	-18	-20	-22	-25	

"PEM" is a registered trademark of Penn Engineering®.  
 Captive Fastener Corporation parts are substitutes for the PEM part numbers in form, fit & function.

JHP Fasteners, Inc.  
 610 Maryland NE - Suite B  
 Grand Rapids, MI 49505

Scale  
 NTS

Drawing No

ST-B

Revision

P - 800.783.0910  
 P - 616.913.0060  
 F - 616.913.0085

Drawn by:

M McCormick