

SPRING-TOP STANDOFFS

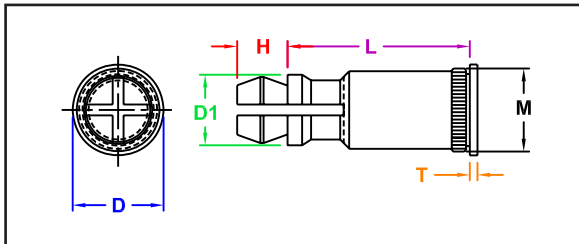

Manufactured by Captive Fastener Corp



CFSSA, CFSSS & CFSSC spring-top standoffs are designed for permanent installation into sheet metal by pressing into a prepared hole. The spring-action post provides quick attachment and removal with a simple snap eliminating the problems associated with loose hardware.

INCH

All Dimension are in inches									
Part Number	Material	Finish	Hole Dia Top +.003 -.000	Hole Dia Bottom +.003 -.000	D1 ± 0.005	M Max	D ± 0.005	H ± 0.005	
CFSSA156	Aluminum	Plain	0.156	0.213	0.188	0.212	0.250	0.141	
CFSSC156	Stainless	Passivated							
CFSSS156	Carbon Steel	Zinc Clear							
Mounting Material, Min Thickness - .040									
					L Length ± 0.005				
0.250	0.312	0.375	0.437	0.500	0.562	0.625	0.750	0.875	1.000
-8	-10	-12	-14	-16	-18	-20	-24	-28	-32

METRIC

All Dimension are in millimeters									
Part Number	Material	Finish	Hole Dia Top +.08 -.00	Hole Dia Bottom +.08 -.00	D1 ± 0.13	M Max	D ± 0.13	H ± 0.13	
CFSSA4MM	Aluminum	Plain	4.0	5.4	4.77	5.38	6.35	3.58	
CFSSC4MM	Stainless	Passivated							
CFSSS4MM	Carbon Steel	Zinc Clear							
Mounting Material, Min Thickness - 1.0									
					L Length ± 0.13				
8	10	12	14	16	18	20	22	25	
-8	-10	-12	-14	-16	-18	-20	-22	-25	

"PEM" is a registered trademark of Penn Engineering®. Captive Fastener Corporation parts are substitutes for the PEM part numbers in form, fit & function.

JHP Fasteners, Inc. 610 Maryland NE - Suite B Grand Rapids, MI 49505	Drawing No ST	P - 800.783.0910 P - 616.913.0060 F - 616.913.0085
Scale NTS	Revision	Drawn by: M McCormick