

## BROACHING-TYPE STANDOFFS

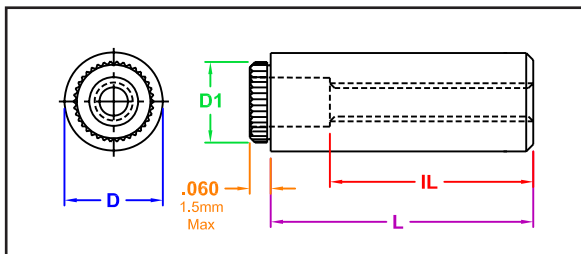

Manufactured by Captive Fastener Corp

**CKFE & CKFSE threaded and non-threaded standoffs allow screws to be inserted through multiple layered boards for stacked assemblies. All fasteners from Captive Fastener are identical to industry standards so that they can be fed through standard automatic insertion equipment.**

### INCH

| Part Number              |                                 | All dimensions are in inches |                 |                             |       |       |       |               |       |       |  |  |              |                               |                     |  |
|--------------------------|---------------------------------|------------------------------|-----------------|-----------------------------|-------|-------|-------|---------------|-------|-------|--|--|--------------|-------------------------------|---------------------|--|
| Thread Size              | Thru Hole<br>+ 0.004<br>- 0.003 | Carbon Steel                 | Stainless Steel | L<br>Length ( ± 0.005 in. ) |       |       |       |               |       |       |  | D1<br>± 0.003                              | D<br>± 0.005 | Hole Size<br>+ .003<br>- .000 | Min Dist<br>to Edge |  |
|                          |                                 |                              |                 | 0.125                       | 0.250 | 0.375 | 0.500 | 0.625         | 0.750 | 0.875 |  |  |              |                               |                     |  |
| Finish                   |                                 | Electro Tin                  | Passivated      |                             |       |       |       |               |       |       |  |  |              |                               |                     |  |
| #4-40                    |                                 | CKFE440                      | CKFSE440        | -4                          | -8    | -12   | -16   | -20           | -24†  |       |  | 0.184                                      | 0.219        | 0.166                         | 0.17                |  |
| #6-32                    |                                 | CKFE632                      | CKFSE632        | -4                          | -8    | -12   | -16   | -20           | -24†  | -28†  |  | 0.231                                      | 0.281        | 0.213                         | 0.22                |  |
|                          | 0.116                           | CKFE116                      | CKFSE116        | -4                          | -8    | -12   | -16   | -20           | -24†  |       |  | 0.184                                      | 0.219        | 0.166                         | 0.17                |  |
|                          | 0.143                           | CKFE143                      | CKFSE143        | -4                          | -8    | -12   | -16   | -20           | -24†  | -28†  |  | 0.231                                      | 0.281        | 0.213                         | 0.22                |  |
| IL=minimum thread length |                                 |                              |                 | Full                        |       |       |       | 0.375 ± 0.015 |       |       |  | † Not stocked, available for special order |              |                               |                     |  |

### METRIC

| Part Number                                   |                                | All dimensions are in millimeters |                 |                      |     |     |     |           |      |      |      |  |               |                              |                     |  |
|---|--------------------------------|-----------------------------------|-----------------|----------------------|-----|-----|-----|-----------|------|------|------|--|---------------|------------------------------|---------------------|--|
| Thread Size                                   | Thru Hole<br>+ 0.010<br>- 0.08 | Carbon Steel                      | Stainless Steel | L<br>Length ± 0.13mm |     |     |     |           |      |      |      | D1<br>± 0.08mm                             | D<br>± 0.13mm | Hole Size<br>+ .08<br>- .000 | Min Dist<br>to Edge |  |
|   |                                |                                   |                 | 3                    | 4   | 6   | 8   | 10        | 12   | 14   | 16   |  |               |                              |                     |  |
| Finish  |                                | Electro Tin                       | Passivated      |                      |     |     |     |           |      |      |      |  |               |                              |                     |  |
| M3 X 0.5                                      |                                | CKFEM3                            | CKFSEM3         | -3                   | -4  | -6  | -8  | -10       | -12  | -14  | -16† | 4.68                                       | 5.56          | 4.2                          | 4.4                 |  |
|   | 3.6                            | CKFE3.6                           | CKFSE3.6        | -3                   | -4  | -6† | -8† | -10†      | -12† | -14† | -16† | 5.87                                       | 7.14          | 5.4                          | 5.5                 |  |
|   | 4.2                            | CKFE4.2                           | CKFSE4.2        | -3†                  | -4† | -6† | -8† | -10†      | -12† | -14† | -16† | 6.81                                       | 8.74          | 6.4                          | 7.1                 |  |
| IL=minimum Thread Length ( Where applicable ) |                                |                                   |                 | Full                 |     |     |     | 9.5 ± 0.4 |      |      |      | † Not stocked, available for special order |               |                              |                     |  |

"PEM" is a registered trademark of Penn Engineering®. Captive Fastener Corporation parts are substitutes for the PEM part numbers in form, fit & function.

|  |                           |  |
|--|---------------------------|--|
| JHP Fasteners, Inc.<br>610 Maryland NE - Suite B<br>Grand Rapids, MI 49505 | Drawing No<br><b>SKFE</b> | P - 800.783.0910<br>P - 616.913.0060<br>F - 616.913.0085 |
| Scale<br>NTS   | Revision                  | Drawn by:<br>M McCormick                                 |