

SELF-CLINCHING STUDS

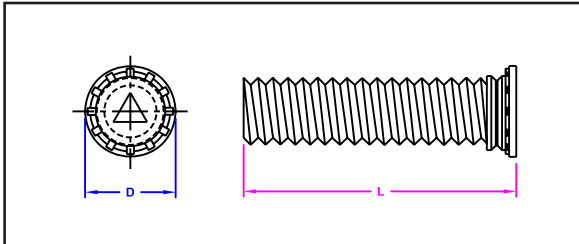

Manufactured by Captive Fastener Corp

CH studs provide a strong flush-head assembly in material as thin as .040 inches (1.0mm) with high torque-out and pushout performance.

INCH

Thread Size	Thread Code	All dimensions are in inches										D ±0.015	Minimum Mat'l Thick	Hole Size +.003 -.000	Recommended * Maximum Nut Tightening Torque - in-lbs	Minimum Distance to Edge
		L Length ± 0.015 inches														
		0.250	0.313	0.375	0.500	0.625	0.750	0.875	1.00	1.25	1.50					
#2-56	256	-4	-5	-6	-8	-10	†-12					0.144	0.040	0.085	2.5	0.187
#4-40	440	-4	-5	-6	-8	-10	-12	-14	†-16			0.176	0.040	0.111	5	0.219
#6-32	632	-4	-5	-6	-8	-10	-12	-14	-16	-20	†-24	0.206	0.040	0.137	10	0.25
#8-32	832	-4	-5	-6	-8	-10	-12	-14	-16	-20	†-24	0.237	0.040	0.163	15	0.281
#10-24	1024		-5	-6	-8	-10	-12	-14	-16	-20	†-24	0.256	0.040	0.189	25	0.281
#10-32	1032		-5	-6	-8	-10	-12	-14	-16	-20	-24	0.256	0.040	0.189	30	0.281
1/4-20	420			-6	-8	-10	-12	-14	-16	-20	-24	0.337	0.062	0.249	55	0.312
5/16-18	518				-8	-10	-12	-14	-16	-20	-24	0.376	0.093	0.311	115	0.375

† Not stocked. Available on special order. *For aluminum studs, values are 60% of those listed.

METRIC

Thread Size	Thread Code	All dimensions are in millimeters.													D ±0.4	Minimum Mat'l Thick	Hole Size +.08 -.00	Recommended Maximum Nut Tightening Torque - N.m	Minimum Distance to Edge
		L Length ± 0.4 mm																	
		6	8	10	12	15	18	20	22	25	28	30	35	38					
M2.5X0.45	M2.5	†6	†8	†10	†12	†15	†18								4.1	1.0	2.5	0.40	5.4
M3X0.5	M3	†6	-8	-10	-12	-15	-18	-20	-22	-25					4.6	1.0	3.0	0.72	5.6
M3.5X0.6	M3.5	-6	-8	-10	-12	-15	-18	-20	-22	-25	-28	-30			5.3	1.0	3.5	1.10	6.4
M4X0.7	M4	-6†	-8	-10	-12	-15	-18	-20	-22	-25	-28	-30	-35	-38	5.9	1.0	4.0	1.60	7.2
M5X0.8	M5		-8†	-10	-12	-15	-18	-20	-22	-25	-28	-30	-35	-38	6.5	1.0	5.0	3.40	7.2
M6X1.0	M6			-10	-12	-15	-18	-20	-22	-25	-28	-30	-35	-38	8.2	1.6	6.0	5.70	7.9
M8X1.25	M8				-12	-15	-18	-20	-22	-25	-28	-30	-35	-38	9.6	2.4	8.0	14.0	9.6

† Not stocked. Available on special order.

"PEM" is a registered trademark of Penn Engineering®. Captive Fastener Corporation parts are substitutes for the PEM part numbers in form, fit & function.

JHP Fasteners, Inc. 610 Maryland NE - Suite B Grand Rapids, MI 49505	Drawing No SFH	P - 800.783.0910 P - 616.913.0060 F - 616.913.0085
Scale NTS	Revision	Drawn by: M McCormick