

# JHP FASTENERS, INC

## SELF-CLINCHING HIGH-TORQUE STUDS

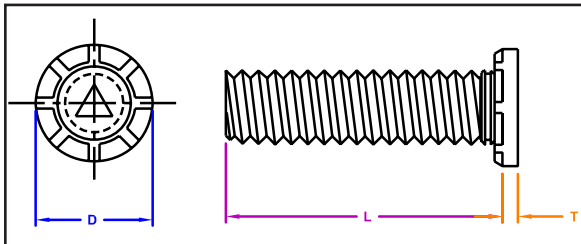

**SERIES**  
 Captive - HCH / HCCHS  
 PEM® - HFH / HFHS  
 JHP Fasteners - SFHH



Manufactured by Captive Fastener Corp

**HCH high-torque studs offer advantages over weld studs and other fasteners. The heavy head configuration provides greater torque-out and improved pull-through resistance.**

### INCH

Thread Size	Thread Code	All dimensions are in inches						Minimum Mat'l Thick	Hole Size +.003 -.000	Max. Hole in Attach. Parts	T (max)	D ±0.015	Minimum Distance to Edge
		L Length ± 0.015 inches											
		0.500	0.750	1.00	1.25	1.50	1.75						
#10-24	1024	-8	-12	-16	-20	-24	-28	0.05	0.190	0.250	0.040	0.300	0.415
#10-32	1032	-8	-12	-16	-20	-24	†-28	0.05	0.190	0.250	0.040	0.300	0.415
1/4-20	420	-8	-12	-16	-20	-24	†-28	0.06	0.250	0.312	0.050	0.380	0.460
5/16-18	518	†-8	-12	-16	-20	-24	†-28	0.075	0.312	0.375	0.070	0.480	0.500
3/8-16	616		-12	-16	-20	-24	†-28	0.09	0.375	0.437	0.085	0.580	0.530

† Not stocked. Available on special order.

### METRIC

Thread Size	Thread Code	All dimensions are in millimeters						Minimum Mat'l Thick	Hole Size +.13 -.000	Max. Hole in Attach. Parts	T (max)	D ±0.25	Minimum Distance to Edge
		L Length ± 0.04mm											
		20	25	30	35	40	50						
M5X0.8	M5	-20	-25	-30				1.3	5.0	6.5	1.14	7.8	10.7
M6X1.0	M6	-20	-25	-30	-35			1.5	6.0	7.5	1.27	9.4	11.5
M8X1.25	M8	-20	-25	-30	-35	-40	-50	2.0	8.0	9.5	1.78	12.5	12.7
M10X1.5	M10	-20	-25	-30	-35	-40	-50	2.3	10	11.5	2.29	15.7	13.7

"PEM" is a registered trademark of Penn Engineering®. Captive Fastener Corporation parts are substitutes for the PEM part numbers in form, fit & function.

JHP Fasteners, Inc. 610 Maryland NE - Suite B Grand Rapids, MI 49505	Drawing No <b>SFHH</b>	P - 800.783.0910 P - 616.913.0060 F - 616.913.0085
Scale <b>NTS</b>	Revision	Drawn by: <b>M McCormick</b>