

SELF-CLINCHING KEY-HOLE STANDOFFS

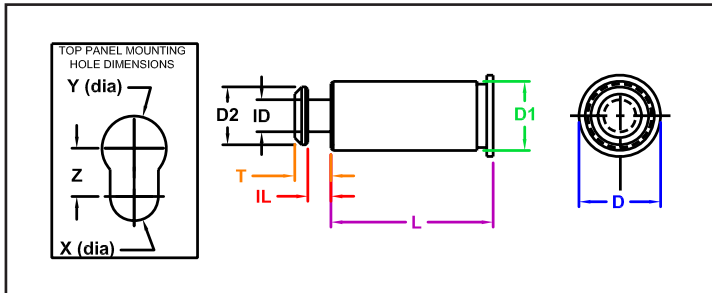

Manufactured by Captive Fastener Corp

CFSKC key-hole standoffs are designed for a PC board or panel to be quickly attached and removed with a simple sliding motion. The key-hole standoffs provide advantages for reducing servicing time and eliminate the problems associated with loose hardware. Several key-hole standoffs can be used in conjunction with a Captive threaded standoff to lock the board in place.



INCH

Part Number	Bottom Panel		All Dimension are in inches						Top Panel - Key Hole Dimensions			
	Mounting Hole Dia Bottom	Min Mat'l Thick	D Nom	D1 Max	D2 ± 0.003	ID ± 0.003	T Max	IL ± 0.003	X ± 0.003	Y ± 0.003	Z Min	Mat'l Thickness Range
300 Series Stainless	+0.003 -0.000											
CFSKC6060	0.213	0.04	0.250	0.212	0.177	0.099	0.108	0.068	0.118	0.197	0.148	.057-.064
L Length ± 0.005												
	0.188	0.250	0.313	0.375	0.438	0.500	0.563	0.625	0.750	0.875	1.00	
	-6	-8	-10	-12	-14	-16	-18	-20	-24	-28	-32	

METRIC

Part Number	Bottom Panel		All Dimension are in millimeters						Top Panel - Key Hole Dimensions			
	Mounting Hole Dia Bottom	Min Mat'l Thick	D Nom	D1 Max	D2 ± 0.08	ID ± 0.08	T Max	IL ± 0.08	X ± 0.08	Y ± 0.08	Z Min	Mat'l Thickness Range
300 Series Stainless	+0.08 -0.00											
CFSKC61.5	5.400	1	6.35	5.38	4.5	2.50	2.75	1.72	3.0	5.0	3.75	1.45-1.62
L Length ± 0.13												
	6	8	10	12	14	16	18	20	22	25		
	-6	-8	-10	-12	-14	-16	-18	-20†	-22†	-25†		

"PEM" is a registered trademark of Penn Engineering®. Captive Fastener Corporation parts are substitutes for the PEM part numbers in form, fit & function.

JHP Fasteners, Inc. 610 Maryland NE - Suite B Grand Rapids, MI 49505	Drawing No KHSO	P - 800.783.0910 P - 616.913.0060 F - 616.913.0085
Scale NTS	Revision	Drawn by: M McCormick