

FLARE-MOUNTED THREADED STANDOFFS

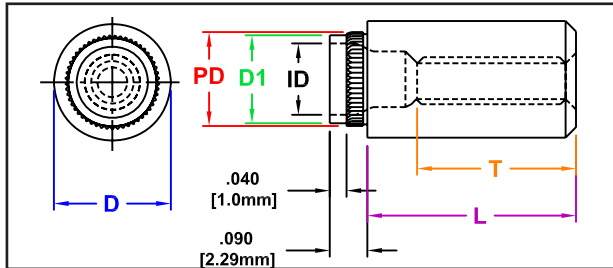

SERIES
Captive - CKFB3
PEM® - KFB3
JHP Fasteners - KFSO



Manufactured by Captive Fastener Corp

CKFB3 flare-mounted threaded standoffs provide a flared shank for stronger holding power and are used for spacing or stacking P-C boards.

INCH

All dimensions are in inches								
Thread Size	Brass Part Number	PD ± 0.003	D1 Max.	ID ± 0.003	D ± 0.005	Hole Size +0.005 -0.001	Min Dist to Edge	Minimum Mat'l Thick
#4-40	CKFB3440	0.179	0.165	0.122	0.22	0.166	0.17	0.050
#6-32	CKFB3632	0.226	0.212	0.171	0.28	0.213	0.22	0.065
Finish	Electro Tin							

L Length ± 0.005 in								
0.063	0.125	0.188	0.250	0.313	0.375	0.500	0.625	0.750
-2	-4	-6	-8	-10	-12	-16	-20	
-2	-4	-6	-8	-10	-12	-16	-20*	-24*
Full						0.375 + 0.015		
T = Minimum Thread Length								

METRIC

All dimensions are in millimeters								
Thread Size	Brass Part Number	PD ± 0.08	D1 Max.	ID ± 0.08	D ± 0.13	Hole Size +0.13 -0.03	Min Dist to Edge	Minimum Mat'l Thick
M3 X 0.5	CKFB3M3	4.55	4.21	3.20	5.56	4.20	4.33	1.27
M4 X 0.7	CKFB3M4	6.68	6.40	5.23	8.74	6.40	6.36	1.65
Finish	Electro Tin							

L Length ± 0.13in								
2	3	4	6	8	10	12	14	16
-2	-3	-4	-6	-8	-10	-12	-14	-16
-2	-3	-4	-6	-8	-10	-12	-14	-16
Full						9.5 ± 0.4		
T = Minimum Thread Length								

"PEM" is a registered trademark of Penn Engineering®. Captive Fastener Corporation parts are substitutes for the PEM part numbers in form, fit & function.

JHP Fasteners, Inc. 610 Maryland NE - Suite B Grand Rapids, MI 49505	Drawing No KFSO	P - 800.783.0910 P - 616.913.0060 F - 616.913.0085
Scale NTS	Revision	Drawn by: M McCormick