

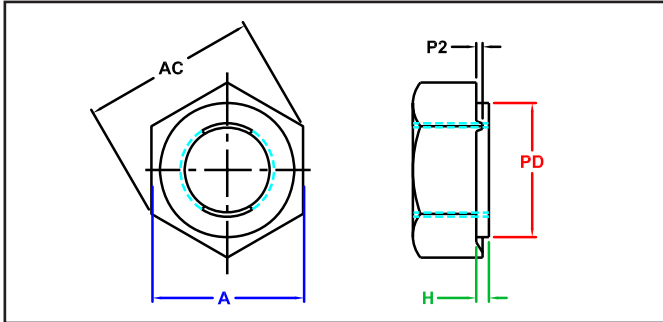

FASTENERS, INC.
HEX PILOTED, 3-PROJECTION, LOCKING WELD NUT

SERIES

**JPHS/L3L
 INCH
 STEEL / PLAIN**



JPH_3L Series - Hex, short and long piloted, locking weld nut with 3 projections. Made from a high-welding quality low carbon steel.

Part Number	Thread Size	AF Width Across Flats		T Thickness		AC Width A.C.	H Pilot Height	PD Pilot Diameter	P2 Projection Height
		Max.	Min.	Max.	Min.				
JPHS3L 1420	1/4-20	0.500	0.489	0.197	0.177	0.556	± 0.005	+0.000 / -0.012	± 0.003
JPHL3L 1420							0.040		0.025
JPHS3L 51618	5/16-18	0.562	0.551	0.229	0.209	0.624	0.085	0.406	0.040
JPHL3L 51618							0.040		0.025
JPHS3L 3816	3/8-16	0.625	0.612	0.260	0.240	0.691	0.085	0.469	0.030
JPHL3L 3816							0.050		0.040
JPHS3L 1213	1/2-13	0.813	0.781	0.385	0.365	0.898	0.085	0.531	0.030
JPHL3L 1213							0.060		0.040

All Dimensions are in Inches

JHP Fasteners, Inc. 3721 Northridge Dr NW - Suite 40 Walker, MI 49544	Drawing No JPH_3L_I	P - 800.783.0910 P - 616.784.7900 F - 616.913.0085
	Scale NTS	Revision